

RECOMMENDED PCB LAYOUT

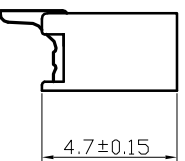
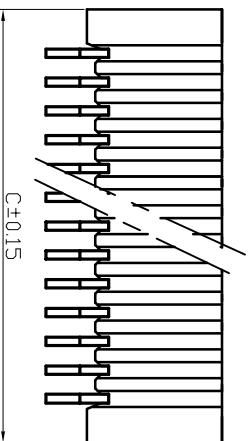

$(A+2.0) \pm 0.1$

$A \pm 0.1$

1.0 ± 0.05

0.7 ± 0.05

0.3 ± 0.03

SPECIFICATION

1. Material:
 - Housing: HIGH-TEMP Plastic, UL94V-0,color: Natural.
 - Lock: HIGH-TEMP Plastic, UL94V-0,color: black.
 - Contacts: Copper alloy.
2. Electrical Characteristics:
 - Current rating: 0.5A(max).
 - Voltage rating: 50V(max), 25°C~+85°C.
 - Operating Temperature: 500M ohms min. at 500V DC.
 - Insulation resistance: 500M ohms min. at 500V DC.
 - Dielectric withstanding voltage: 500V AC/minute.
 - Contact resistance: 30m ohms max.

Pin 位	A	B	C	Pin 位	A	B	C
4	3	5.06	6	24	23	25.06	26
5	4	6.06	7	25	24	26.06	27
6	5	7.06	8	26	25	27.06	28
7	6	8.06	9	27	26	28.06	29
8	7	9.06	10	28	27	29.06	30
9	8	10.06	11	29	28	30.06	31
10	9	11.06	12	30	29	31.06	32
11	10	12.06	13	31	30	32.06	33
12	11	13.06	14	32	31	33.06	34
13	12	14.06	15	33	32	34.06	35
14	13	15.06	16	34	33	35.06	36
15	14	16.06	17	35	34	36.06	37
16	15	17.06	18	36	35	37.06	38
17	16	18.06	19	37	36	38.06	39
18	17	19.06	20	38	37	39.06	40
19	18	20.06	21	39	38	40.06	41
20	19	21.06	22	40	39	41.06	42
21	20	22.06	23				
22	21	23.06	24				
23	22	24.06	25				

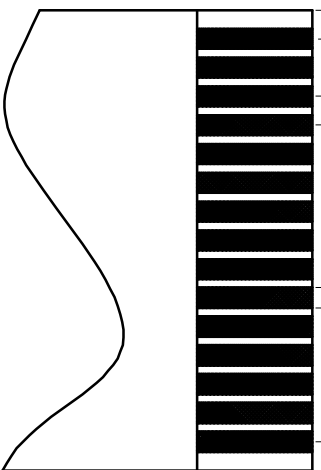

UNITS: mm		CSCONN		CSCONN PRECISE ELECTRONICS CO.,LTD			
GENERAL TOLERANCE		PART NO. (INTENDED USE)		TITLE: FPC 1.0MM XP SMT 无锁			
X.° ±5°	0.X±0.25	CP102802XX001		DWG NO. FPC			
X.1±2°	0.XX±0.2	APPD:		SCALE SHEET			
XX ±1°	0.XXX±0.1	CHKD: Skila		1:1 1 OF 1 A			
		DR: Kitty		REV			